



7 WALDEN ROAD

CITY OF PORTSMOUTH, PO2 8PH

£224,995
FREEHOLD

Located with in the requested Stamshaw village area of Portsmouth on the east side of the island an established terraced district circa 1900 which offers a wide range of local amenities and is situated within the immediate vicinity of the Mountbatten Sports center in Alexandra Park, at the shore line inner waterway. This mid terraced house has been refurbished and redecorated by the present owners to a high standard, blending contemporary styling with period architecture. The accommodation comprises two partially open plan reception rooms, a modernised kitchen breakfast room a modernised family bathroom with two double bedrooms to the upper level. Features include a southerly aspect landscaped rear garden with full with store. Internal viewing essential to fully appreciate the size and layout of this mid terraced bay and forecourt, starter family home. Ideal Landlord, Freehold rental investment. View Today..?



THIS FLOOR PLAN IS NOT DRAWN TO SCALE & IS FOR GUIDANCE PURPOSES ONLY

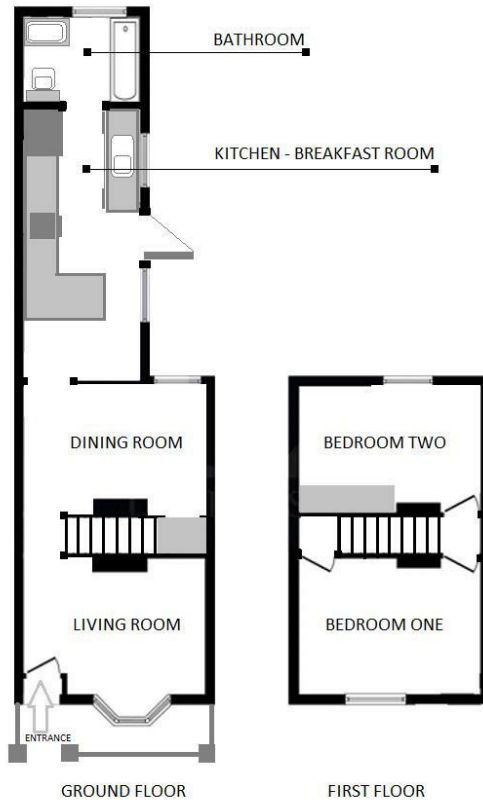

Energy Efficiency Rating		Current	Potential
Very energy efficient - lower running costs			
(92 plus) A			
(81-91) B			
(69-80) C			
(55-68) D		52	
(39-54) E			
(21-38) F			
(1-20) G			
Not energy efficient - higher running costs			
England & Wales		EU Directive 2002/91/EC	

Agents Note: Whilst every care has been taken to prepare these particulars, they are for guidance purposes only. All measurements are approximate and are for general guidance purposes only and whilst every care has been taken to ensure their accuracy, they should not be relied upon and potential buyers/tenants are advised to recheck the measurements

Southsea Office Sales
 97 Albert Road
 Southsea
 Hampshire
 PO5 2SG

02392 830888
 sales@christieuk.com
 www.christieuk.com

